



Features 特点

- ◆ High current capacity , Low core loss at high frequency power application
大电流，低损耗，高频下应用
- ◆ Suitable for reflow soldering
适用于回流焊工艺
- ◆ Provided in embossed carrier tape packaging for use with automatic mounting machines
编带包装便于自动贴装

Application 应用

- ◆ Ideally used in Portable telephones, PDA, DSC, DC-DC Converters, etc
用于手机、掌上电脑、数字信号控制器、DC-DC 转换等

Product Identification 产品标识

MDR - 0301 - 100 M

① ② ③ ④

- ① Series name 系列名称
- ② Product dimensions 产品尺寸：(31B=d3.5*h1.5mm)
- ③ Inductance Value 电感量：(100=10μH)
- ④ Inductance Tolerance 电感量公差：(M:20%;N:30%)
- ⑤ Tape Packing 编带包装

Shapes And Dimensions/Recommended Footprint 外形及焊位尺寸示意图

Fig1

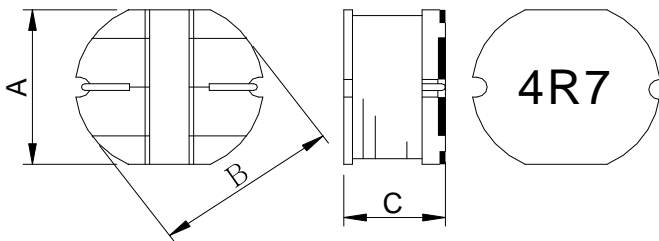
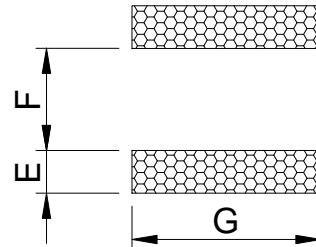

Fig2 Recommended Land Pattern 焊盘规格



Series	Shape	A	B	C	E	F	G
MDR-0301	Fig1	3.0±0.3	3.5±0.3	1.5±0.3	0.8Typ	1.6Typ	3.5Typ
MDR-0302	Fig1	3.0±0.3	3.5±0.3	2.1±0.3	0.8Typ	1.6Typ	3.5Typ
MDR-0403	Fig1	4.0±0.3	4.5±0.3	3.2±0.3	1.9Typ	1.2Typ	4.5Typ
MDR-0503	Fig1	5.2±0.3	5.8±0.3	3.0±0.3	2.2Typ	1.6Typ	5.4Typ
MDR-0504	Fig1	5.2±0.3	5.8±0.2	4.5±0.3	2.2Typ	1.6Typ	5.4Typ
MDR-0703	Fig1	7.0±0.3	7.8±0.3	3.5±0.3	3.0Typ	2.0Typ	7.5Typ
MDR-0705	Fig1	7.0±0.3	7.8±0.3	5.0±0.3	3.0Typ	2.0Typ	7.5Typ
MDR-1004	Fig1	9.0±0.3	10.0±0.3	4.0±0.3	3.75Typ	2.5Typ	9.5yp



Electrical Characteristics 电气特性

MDR0301 系列							
MING-CI	Inductance	Percent	L Test	DC Resistance	Rated Current	Rated Current	Marking
P/N	L(μ H)	Tolerance	Frequency	DCR (m Ω)	Isat(A)	Irms(A)	
MDR-0301-1R0N	1.00	\pm 30%	100KHz,0.3V	48 MAX	1.6A	1.6A	1R0
MDR-0301-1R5N	1.50	\pm 30%	100KHz,0.3V	100 MAX	1.55A	1.55A	1R5
MDR-0301-2R2N	2.20	\pm 30%	100KHz,0.3V	78MAX	1.47A	1.47A	2R2
MDR-0301-3R3M	3.30	\pm 20%	100KHz,0.3V	126 MAX	1.34A	1.34A	3R3
MDR-0301-3R9M	3.90	\pm 20%	100KHz,0.3V	140 MAX	1.24A	1.24A	3R9
MDR-0301-4R7M	4.70	\pm 20%	100KHz,0.3V	158 MAX	1.22A	1.22A	4R7
MDR-0301-5R6M	5.60	\pm 20%	100KHz,0.3V	186 MAX	1.09A	1.09A	5R6
MDR-0301-6R8M	6.80	\pm 20%	100KHz,0.3V	213MAX	0.96A	0.96A	6R8
MDR-0301-8R2M	8.20	\pm 20%	100KHz,0.3V	238 MAX	0.84A	0.84A	8R2
MDR-0301-100M	10.00	\pm 20%	1KHz,0.3V	307 MAX	0.70A	0.70A	100
MDR-0301-120M	12.00	\pm 20%	1KHz,0.3V	372 MAX	0.65A	0.65A	120
MDR-0301-150M	15.00	\pm 20%	1KHz,0.3V	466 MAX	0.59A	0.59A	150
MDR-0301180M	18.00	\pm 20%	1KHz,0.3V	515 MAX	0.54A	0.54A	180
MDR-0301-220M	22.00	\pm 20%	1KHz,0.3V	656 MAX	0.48A	0.48A	220
MDR-0301-270M	27.00	\pm 20%	1KHz,0.3V	774 MAX	0.43A	0.43A	270
MDR-0301-330M	33.00	\pm 20%	1KHz,0.3V	1021 MAX	0.37A	0.37A	330
MDR-0301-390M	39.00	\pm 20%	1KHz,0.3V	1122MAX	0.32A	0.32A	390
MDR-0301-470M	47.00	\pm 20%	1KHz,0.3V	1509MAX	0.26A	0.26A	470
MDR-0301-560M	56.00	\pm 20%	1KHz,0.3V	1675MAX	0.24A	0.24A	560
MDR-0301-680M	68.00	\pm 20%	1KHz,0.3V	2919MAX	0.23A	0.23A	680
MDR-0301-820M	82.00	\pm 20%	1KHz,0.3V	2644MAX	0.21A	0.21A	820
MDR-0301-101M	100.00	\pm 20%	1KHz,0.3V	2870MAX	0.19A	0.19A	101

Isat: Direct current at which the inductance drops approximate 25% from its value without current.

Irms: Direct current when the temperature of the product rise($\Delta T=40^{\circ}C$) from $20^{\circ}C$ ambient.

MDR0302 系列

MING-CI	Inductance	Percent	L Test	DC Resistance	Rated Current	Rated Current	Marking
P/N	L(μ H)	Tolerance	Frequency	DCR (m Ω)	Isat(A)	Irms(A)	
MDR-0302-1R0N	1.00	\pm 30%	100KHz,0.3V	35MAX	3.34A	3.34A	1R0
MDR-0302-2R2N	2.20	\pm 30%	100KHz,0.3V	59MAX	2.35A	2.35A	2R2
MDR-0302-3R3M	3.30	\pm 20%	100KHz,0.3V	98 MAX	1.83A	1.83A	3R3
MDR-0302-4R7M	4.70	\pm 20%	100KHz,0.3V	137MAX	1.50A	1.50A	4R7
MDR-0302-5R6M	5.60	\pm 20%	100KHz,0.3V	157MAX	1.36A	1.36A	5R6
MDR-0302-6R8M	6.80	\pm 20%	100KHz,0.3V	196MAX	1.22A	1.22A	6R8
MDR-0302-8R2M	8.20	\pm 20%	100KHz,0.3V	230MAX	1.09A	1.09A	8R2
MDR-0302100M	10.00	\pm 20%	1KHz,0.3V	286MAX	0.95A	0.95A	100
MDR-0302-120M	12.00	\pm 20%	1KHz,0.3V	322MAX	0.88A	0.88A	120
MDR-0302-150M	15.00	\pm 20%	1KHz,0.3V	398MAX	0.82A	0.82A	150



MDR-0302-180M	18.00	±20%	1KHz,0.3V	520 MAX	0.76A	0.76A	180
MDR-0302-220M	22.00	±20%	1KHz,0.3V	660 MAX	0.63A	0.63A	220
MDR-0302-270M	27.00	±20%	1KHz,0.3V	760 MAX	0.62A	0.62A	270
MDR-0302-330M	33.00	±20%	1KHz,0.3V	870 MAX	0.56A	0.56A	330
MDR-0302-390M	39.00	±20%	1KHz,0.3V	1100MAX	0.51A	0.51A	390
MDR-0302-470M	47.00	±20%	1KHz,0.3V	1250MAX	0.47A	0.47A	470
MDR-0302-560M	56.00	±20%	1KHz,0.3V	1590MAX	0.42A	0.42A	560
MDR-0302-680M	68.00	±20%	1KHz,0.3V	1820MAX	0.38A	0.38A	680
MDR-0302-820M	82.00	±20%	1KHz,0.3V	2440MAX	0.34A	0.34A	820
MDR-0302-101M	100.00	±20%	1KHz,0.3V	2840MAX	0.31A	0.31A	101
MDR-0302-121M	120.00	±20%	1KHz,0.3V	3190MAX	0.28A	0.28A	121
MDR-0302-151M	150.00	±20%	1KHz,0.3V	4200MAX	0.16A	0.16A	151
MDR-0302-181M	180.00	±20%	1KHz,0.3V	5110MAX	0.15A	0.15A	181
MDR-0302-221M	220.00	±20%	1KHz,0.3V	7310MAX	0.14A	0.14A	221
MDR-0302-271M	270.00	±20%	1KHz,0.3V	8240MAX	0.12A	0.12A	271
MDR-0302-331M	330.00	±20%	1KHz,0.3V	1019MAX	0.10A	0.10A	331

Isat: Direct current at which the inductance drops approximate 30% from its value without current.

Irms: Direct current when the temperature of the product rise($\Delta T=40^{\circ}\text{C}$) from 20°C ambient.

MDR-0403 系列

MING-CI	Inductance	Percent	L Test	DC Resistance	Rated Current	Rated Current	Marking
P/N	L(μH)	Tolerance	Frequency	DCR (m Ω)	Isat(A)	Irms(A)	
MDR-4030-1R0N	1.00	±30%	100KHz,0.3V	33MAX	3.80A	3.80A	1R0
MDR-4030-2R2N	2.20	±30%	100KHz,0.3V	47MAX	2.60A	2.60A	2R2
MDR-4030-2R7M	2.70	±20%	100KHz,0.3V	52 MAX	2.43A	2.43A	2R7
MDR-4030-3R3M	3.30	±20%	100KHz,0.3V	58MAX	2.15A	2.15A	3R3
MDR-4030-4R7M	4.70	±20%	100KHz,0.3V	94MAX	1.70A	1.70A	4R7
MDR-4030-6R8M	6.80	±20%	100KHz,0.3V	117MAX	1.41A	1.41A	6R8
MDR-4030-8R2M	8.20	±20%	100KHz,0.3V	132MAX	1.26A	1.26A	8R2
MDR-4030-100M	10.00	±20%	1KHz,0.3V	182MAX	1.15A	1.15A	100
MDR-4030-120M	12.00	±20%	1KHz,0.3V	210MAX	1.05A	1.05A	120
MDR-4030-150M	15.00	±20%	1KHz,0.3V	235MAX	0.92A	0.92A	150
MDR-4030-180M	18.00	±20%	1KHz,0.3V	338 MAX	0.84A	0.84A	180
MDR-4030-220M	22.00	±20%	1KHz,0.3V	378MAX	0.76A	0.76A	220
MDR-4030-270M	27.00	±20%	1KHz,0.3V	522 MAX	0.71A	0.71A	270
MDR-4030-330M	33.00	±20%	1KHz,0.3V	540 MAX	0.64A	0.64A	330
MDR-4030-390M	39.00	±20%	1KHz,0.3V	587MAX	0.59A	0.59A	390
MDR-4030-470M	47.00	±20%	1KHz,0.3V	844MAX	0.54A	0.54A	470
MDR-4030-560M	56.00	±20%	1KHz,0.3V	937MAX	0.50A	0.50A	560
MDR-4030-680M	68.00	±20%	1KHz,0.3V	1117MAX	0.46A	0.46A	680
MDR-4030-820M	82.00	±20%	1KHz,0.3V	1180MAX	0.43A	0.43A	820
MDR-4030-101M	100.00	±20%	1KHz,0.3V	1190MAX	0.41A	0.41A	101



MDR-4030-121M	120.00	±20%	1KHz,0.3V	1220MAX	0.38A	0.38A	121
MDR-4030-151M	150.00	±20%	1KHz,0.3V	1400MAX	0.35A	0.35A	151
MDR-4030-181M	180.00	±20%	1KHz,0.3V	1500MAX	0.31A	0.31A	181
MDR-4030-221M	220.00	±20%	1KHz,0.3V	1641MAX	0.29A	0.29A	221
MDR-4030-271M	270.00	±20%	1KHz,0.3V	2890MAX	0.26A	0.26A	271
MDR-4030-331M	330.00	±20%	1KHz,0.3V	3760MAX	0.20A	0.20A	331

Isat: Direct current at which the inductance drops approximate 30% from its value without current.

Irms: Direct current when the temperature of the product rise($\Delta T=40^{\circ}\text{C}$) from 20°C ambient.

MDR-0503 系列

MING-CI	Inductance	Percent	L Test	DC Resistance	Rated Current	Rated Current	Marking
P/N	L(μH)	Tolerance	Frequency	DCR (m Ω)	Isat(A)	Irms(A)	
MDR-0503-1R0N	1.00	±30%	100KHz,0.3V	38MAX	4.5A	4.5A	1R0
MDR-0503-2R2N	2.20	±30%	100KHz,0.3V	45MAX	3.5A	3.5A	2R2
MDR-0503-3R3M	3.30	±20%	100KHz,0.3V	55 MAX	2.8A	2.8A	3R3
MDR-0503-4R7M	4.70	±20%	100KHz,0.3V	72MAX	2.5A	2.5A	4R7
MDR-0503-5R6M	5.60	±20%	100KHz,0.3V	84MAX	2.4A	2.4A	5R6
MDR-05036R8M	6.80	±20%	100KHz,0.3V	90MAX	2.2A	2.2A	6R8
MDR-0503-8R2M	8.20	±20%	100KHz,0.3V	100MAX	2.0A	2.0A	8R2
MDR-0503-100M	10.00	±20%	1KHz,0.3V	120MAX	1.8A	1.8A	100
MDR-0503-120M	12.00	±20%	1KHz,0.3V	130MAX	1.75A	1.75A	120
MDR-0503150M	15.00	±20%	1KHz,0.3V	150MAX	1.70A	1.70A	150
MDR-0503180M	18.00	±20%	1KHz,0.3V	180 MAX	1.60A	1.60A	180
MDR-0503-220M	22.00	±20%	1KHz,0.3V	220 MAX	1.50A	1.50A	220
MDR-0503-270M	27.00	±20%	1KHz,0.3V	240 MAX	1.40A	1.40A	270
MDR-0503-330M	33.00	±20%	1KHz,0.3V	300 MAX	1.10A	1.10A	330
MDR-0503-390M	39.00	±20%	1KHz,0.3V	400MAX	1.00A	1.00A	390
MDR-0503-470M	47.00	±20%	1KHz,0.3V	430MAX	0.90A	0.90A	470
MDR-0503-560M	56.00	±20%	1KHz,0.3V	500MAX	0.85A	0.85A	560
MDR-0503-680M	68.00	±20%	1KHz,0.3V	600MAX	0.80A	0.80A	680
MDR-0503-820M	82.00	±20%	1KHz,0.3V	800MAX	0.65A	0.65A	820
MDR-0503-101M	100.00	±20%	1KHz,0.3V	900MAX	0.60A	0.60A	101
MDR-0503-121M	120.00	±20%	1KHz,0.3V	1000MAX	0.58A	0.58A	121
MDR-0503-151M	150.00	±20%	1KHz,0.3V	1300MAX	0.43A	0.43A	151
MDR-0503-181M	180.00	±20%	1KHz,0.3V	1500MAX	0.41A	0.41A	181
MDR-0503-221M	220.00	±20%	1KHz,0.3V	2000MAX	0.38A	0.38A	221
MDR-0503-271M	270.00	±20%	1KHz,0.3V	2500MAX	0.35A	0.35A	271
MDR-0503-331M	330.00	±20%	1KHz,0.3V	3200MAX	0.28A	0.28A	331

Isat: Direct current at which the inductance drops approximate 30% from its value without current.

Irms: Direct current when the temperature of the product rise($\Delta T=40^{\circ}\text{C}$) from 20°C ambient



MDR-0504 系列

MING-CI	Inductance	Percent	L Test	DC Resistance	Rated Current	Rated Current	Marking
P/N	L(μ H)	Tolerance	Frequency	DCR (mΩ)	Isat(A)	Irms(A)	
MDR-0504-1R0N	1.00	±30%	100KHz,0.3V	20MAX	5.0A	5.0A	1R0
MDR-0504-1R5N	1.50	±30%	100KHz,0.3V	25MAX	4.8A	4.8A	1R5
MDR-0504-2R2N	2.20	±30%	100KHz,0.3V	17MAX	4.5A	4.5A	2R2
MDR-0504-2R7N	2.70	±30%	100KHz,0.3V	30MAX	3.5A	3.5A	2R7
MDR-0504-3R3M	3.30	±20%	100KHz,0.3V	34MAX	3.0A	3.0A	3R3
MDR-0504-4R7M	4.70	±20%	100KHz,0.3V	40MAX	2.8A	2.8A	4R7
MDR-0504-6R8M	6.80	±20%	100KHz,0.3V	80MAX	2.5A	2.5A	6R8
MDR-0504-100M	10.00	±20%	1KHz,0.3V	100MAX	1.44A	1.44A	100
MDR-0504-120M	12.00	±20%	1KHz,0.3V	120MAX	1.40A	1.40A	120
MDR-0504-150M	15.00	±20%	1KHz,0.3V	140MAX	1.30A	1.30A	150
MDR-0504-180M	18.00	±20%	1KHz,0.3V	150MAX	1.23A	1.23A	180
MDR-0504-220M	22.00	±20%	1KHz,0.3V	180MAX	1.11A	1.11A	220
MDR-0504-270M	27.00	±20%	1KHz,0.3V	200MAX	0.97A	0.97A	270
MDR-0504-330M	33.00	±20%	1KHz,0.3V	230MAX	0.88A	0.88A	330
MDR-0504-390M	39.00	±20%	1KHz,0.3V	320MAX	0.80A	0.80A	390
MDR-0504-470M	47.00	±20%	1KHz,0.3V	370MAX	0.72A	0.72A	470
MDR-0504-560M	56.00	±20%	1KHz,0.3V	420MAX	0.68A	0.68A	560
MDR-0504-680M	68.00	±20%	1KHz,0.3V	460MAX	0.61A	0.61A	680
MDR-0504-820M	82.00	±20%	1KHz,0.3V	600MAX	0.58A	0.58A	820
MDR-0504-101M	100.00	±20%	1KHz,0.3V	700MAX	0.52A	0.52A	101
MDR-0504-121M	120.00	±20%	1KHz,0.3V	930MAX	0.48A	0.48A	121
MDR-0504-151M	150.00	±20%	1KHz,0.3V	1100MAX	0.40A	0.40A	151
MDR-0504-181M	180.00	±20%	1KHz,0.3V	1380MAX	0.38A	0.38A	181
MDR-0504-221M	220.00	±20%	1KHz,0.3V	1570MAX	0.35A	0.35A	221

Isat: Direct current at which the inductance drops approximate 30% from its value without current.

Irms: Direct current when the temperature of the product rise(ΔT=40°C) from 20°C ambient

MDR-0775 系列

MING-CI	Inductance	Percent	L Test	DC Resistance	Rated Current	Rated Current	Marking
P/N	L(μ H)	Tolerance	Frequency	DCR (mΩ)	Isat(A)	Irms(A)	
MDR-0705-1R0N	1.00	±30%	100KHz,0.3V	13MAX	7.5A	7.5A	1R0
MDR-0705-2R2N	2.20	±30%	100KHz,0.3V	23MAX	5.3A	5.3A	2R2
MDR-0705-3R3M	3.30	±20%	100KHz,0.3V	28MAX	4.5A	4.5A	3R3
MDR-0705-4R7M	4.70	±20%	100KHz,0.3V	45MAX	4.0A	4.0A	4R7
MDR-0705-6R8M	6.80	±20%	100KHz,0.3V	58MAX	3.2A	3.2A	6R8
MDR-0705-8R2M	8.20	±20%	100KHz,0.3V	70MAX	2.8A	2.8A	8R2
MDR-0705-100M	10.00	±20%	1KHz,0.3V	70MAX	2.3A	2.3A	100
MDR-0705-120M	12.00	±20%	1KHz,0.3V	80MAX	2.0A	2.0A	120
MDR-0705-150M	15.00	±20%	1KHz,0.3V	90MAX	1.8A	1.8A	150



MDR-0705-180M	18.00	±20%	1KHz,0.3V	100MAX	1.6A	1.6A	180
MDR-0705-220M	22.00	±20%	1KHz,0.3V	110MAX	1.5A	1.5A	220
MDR-0705-270M	27.00	±20%	1KHz,0.3V	120MAX	1.3A	1.3A	270
MDR-0705-330M	33.00	±20%	1KHz,0.3V	130MAX	1.2A	1.2A	330
MDR-0705-390M	39.00	±20%	1KHz,0.3V	160MAX	1.1A	1.1A	390
MDR-0705-470M	47.00	±20%	1KHz,0.3V	180MAX	1.0A	1.0A	470
MDR-0705-560M	56.00	±20%	1KHz,0.3V	240MAX	0.94A	0.94A	560
MDR-0705-680M	68.00	±20%	1KHz,0.3V	280MAX	0.85A	0.85A	680
MDR-0705-820M	82.00	±20%	1KHz,0.3V	370MAX	0.78A	0.78A	820
MDR-0705-101M	100.00	±20%	1KHz,0.3V	430MAX	0.72A	0.72A	101
MDR-0705-121M	120.00	±20%	1KHz,0.3V	470MAX	0.66A	0.66A	121
MDR-0705-151M	150.00	±20%	1KHz,0.3V	640MAX	0.58A	0.58A	151
MDR-0705-181M	180.00	±20%	1KHz,0.3V	710MAX	0.51A	0.51A	181
MDR-0705-221M	220.00	±20%	1KHz,0.3V	960MAX	0.49A	0.49A	221
MDR-0705-271M	270.00	±20%	1KHz,0.3V	1110MAX	0.42A	0.42A	271
MDR-0705-331M	330.00	±20%	1KHz,0.3V	1260MAX	0.40A	0.40A	331
MDR-0705-391M	390.00	±20%	1KHz,0.3V	1770MAX	0.36A	0.36A	391
MDR-0705-471M	470.00	±20%	1KHz,0.3V	1960MAX	0.34A	0.34A	471

Isat: Direct current at which the inductance drops approximate 30% from its value without current.

Irms: Direct current when the temperature of the product rise($\Delta T=40^{\circ}C$) from $20^{\circ}C$ ambient

MDR-1004 系列

MING-CI	Inductance	Percent	L Test	DC Resistance	Rated Current	Rated Current	Marking
P/N	L(μH)	Tolerance	Frequency	DCR (m Ω)	Isat(A)	Irms(A)	
MDR-1004-1R0N	1.00	±30%	100KHz,0.3V	12MAX	8.7A	8.7A	1R0
MDR-1004-2R2N	2.20	±30%	100KHz,0.3V	20MAX	5.4A	5.4A	2R2
MDR1004-3R3M	3.30	±20%	100KHz,0.3V	28MAX	2.85A	2.85A	3R3
MDR-1004-4R7M	4.70	±20%	100KHz,0.3V	38MAX	2.75A	2.75A	4R7
MDR-1004-5R6M	5.60	±20%	100KHz,0.3V	40MAX	2.70A	2.70A	5R6
MDR-1004-6R8M	6.80	±20%	100KHz,0.3V	42MAX	2.65A	2.65A	6R8
MDR-1004-8R2M	8.20	±20%	100KHz,0.3V	48MAX	2.60A	2.60A	8R2
MDR-1004-100M	10.00	±20%	1KHz,0.3V	50MAX	2.38A	2.38A	100
MDR-1004-150M	15.00	±20%	1KHz,0.3V	70MAX	1.87A	1.87A	150
MDR-1004-180M	18.00	±20%	1KHz,0.3V	80MAX	1.73A	1.73A	180
MDR-1004-220M	22.00	±20%	1KHz,0.3V	90MAX	1.60A	1.60A	220
MDR-1004-270M	27.00	±20%	1KHz,0.3V	100MAX	1.44A	1.44A	270
MDR-1004-330M	33.00	±20%	1KHz,0.3V	120MAX	1.26A	1.26A	330
MDR-1004-390M	39.00	±20%	1KHz,0.3V	150MAX	1.20A	1.20A	390
MDR-1004-470M	47.00	±20%	1KHz,0.3V	170MAX	1.10A	1.10A	470
MDR-1004-560M	56.00	±20%	1KHz,0.3V	200MAX	1.01A	1.01A	560
MDR-1004-680M	68.00	±20%	1KHz,0.3V	220MAX	0.91A	0.91A	680
MDR-1004-820M	82.00	±20%	1KHz,0.3V	250MAX	0.85A	0.85A	820
MDR-1004-101M	100.00	±20%	1KHz,0.3V	340MAX	0.74A	0.74A	101
MDR1004-121M	120.00	±20%	1KHz,0.3V	400MAX	0.69A	0.69A	121



MDR-1004-151M	150.00	±20%	1KHz,0.3V	540MAX	0.61A	0.61A	151
MDR-1004-181M	180.00	±20%	1KHz,0.3V	620MAX	0.56A	0.56A	181
MDR-1004-221M	220.00	±20%	1KHz,0.3V	720MAX	0.53A	0.53A	221
MDR-1004-271M	270.00	±20%	1KHz,0.3V	950MAX	0.45A	0.45A	271
MDR-1004-331M	330.00	±20%	1KHz,0.3V	1100MAX	0.42A	0.42A	331
MDR-1004-391M	390.00	±20%	1KHz,0.3V	1240MAX	0.38A	0.38A	391
MDR-1004-471M	470.00	±20%	1KHz,0.3V	1530MAX	0.35A	0.35A	471
MDR-1004-561M	560.00	±20%	1KHz,0.3V	1900MAX	0.32A	0.32A	561

Isat: Direct current at which the inductance drops approximate 30% from its value without current.

Irms: Direct current when the temperature of the product rise($\Delta T=40^{\circ}\text{C}$) from 20°C ambient.

MDR-0703 系列

MING-CI	Inductance	Percent	L Test	DC Resistance	Rated Current	Rated Current	Marking
P/N	L(μH)	Tolerance	Frequency	DCR (m Ω)	Isat(A)	Irms(A)	
MDR-0703-1R0N	1.00	±30%	100KHz,0.3V	18MAX	7.0A	7.0A	1R0
MDR-0703-1R5N	1.50	±30%	100KHz,0.3V	20MAX	6.0A	6.0A	1R5
MDR-0703-2R2N	2.20	±30%	100KHz,0.3V	23MAX	5.0A	5.0A	2R2
MDR-0703-3R3M	3.30	±20%	100KHz,0.3V	25MAX	4.0A	4.0A	3R3
MDR-0703-4R7M	4.70	±20%	100KHz,0.3V	39MAX	3.5A	3.5A	4R7
MDR-0703-6R8M	6.80	±20%	100KHz,0.3V	40MAX	2.8A	2.8A	6R8
MDR-0703-100M	10.00	±20%	1KHz,0.3V	80MAX	1.44A	1.44A	100
MDR-0703-120M	12.00	±20%	1KHz,0.3V	90MAX	1.39A	1.39A	120
MDR-0703-150M	15.00	±20%	1KHz,0.3V	100MAX	1.24A	1.24A	150
MDR-0703-180M	18.00	±20%	1KHz,0.3V	110MAX	1.12A	1.12A	180
MDR-0703-220M	22.00	±20%	1KHz,0.3V	130MAX	1.07A	1.07A	220
MDR-0703-270M	27.00	±20%	1KHz,0.3V	150MAX	0.94A	0.94A	270
MDR-0703-330M	33.00	±20%	1KHz,0.3V	170MAX	0.85A	0.85A	330
MDR-0703-390M	39.00	±20%	1KHz,0.3V	220MAX	0.74A	0.74A	390
MDR-0703-470M	47.00	±20%	1KHz,0.3V	250MAX	0.68A	0.68A	470
MDR-0703-560M	56.00	±20%	1KHz,0.3V	280MAX	0.64A	0.64A	560
MDR-0703-680M	68.00	±20%	1KHz,0.3V	330MAX	0.59A	0.59A	680
MDR-0703-820M	82.00	±20%	1KHz,0.3V	410MAX	0.54A	0.54A	820
MDR-0703-101M	100.00	±20%	1KHz,0.3V	480MAX	0.51A	0.51A	101
MDR-0703-121M	120.00	±20%	1KHz,0.3V	540MAX	0.49A	0.49A	121

Isat: Direct current at which the inductance drops approximate 30% from its value without current.

Irms: Direct current when the temperature of the product rise($\Delta T=40^{\circ}\text{C}$) from 20°C ambient.



Taping Dimension 包装尺寸

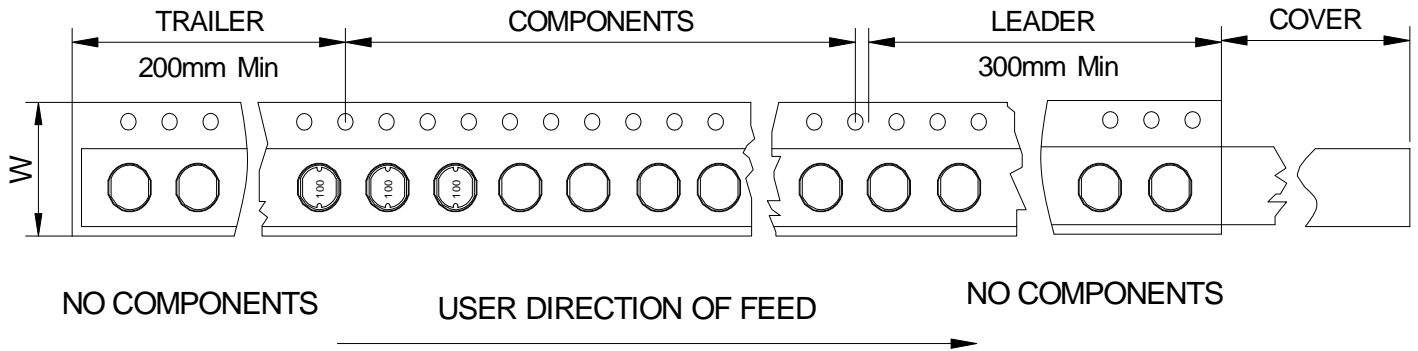

Series	Qty per Reel	Reel Size	Reel Box	Outer Box
MDR-0301	1000PCS	7Inch*12width	4000PCS(187*187*77mm)	12000PCS(210*210*280mm)
MDR-0302	3000PCS	13Inch*12width	12000PCS(340*340*75mm)	36000PCS(358*358*250mm)
MDR-0403	2000PCS	13Inch*12width	8000PCS(340*340*75mm)	24000PCS(358*358*250mm)
MDR-0503	2000PCS	13Inch*16width	6000PCS(340*340*75mm)	18000PCS(358*358*250mm)
MDR-0504	1500PCS	13Inch*16width	4500PCS(340*340*75mm)	13500PCS(358*358*250mm)
MDR-0703	1000PCS	13Inch*16width	3000PCS(340*340*75mm)	9000PCS(358*358*250mm)
MDR-0705	1000PCS	13Inch*16width	3000PCS(340*340*75mm)	9000PCS(358*358*250mm)
MDR-1004	1000PCS	13Inch*24width	2000PCS(340*340*75mm)	6000PCS(358*358*250mm)